

Externalsize :
W*2200*D 2136*H 2346
Unit : mm

- Thanks for choosingour product, please mind these tips below during the installation:
1. Two people should be prepared for the installation.
 2. Please use cushioning material for stacking parts after unboxing in case of damaging floor or product.
 3. Please don't scratch any piece with a sharp tool.
 4. Please check all listed tools are prepared.
 5. Please check the space for installation is sufficient.
 6. Please follow the step by number to build.

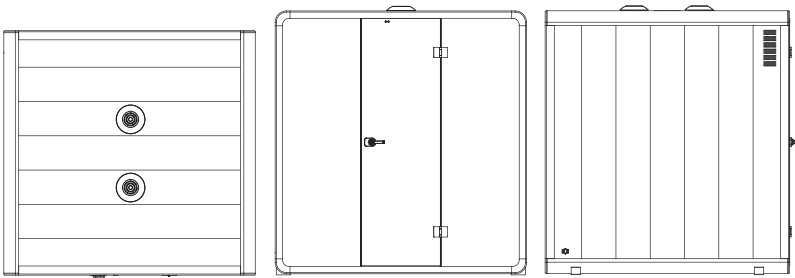

CIRCUIT DIAGRAM

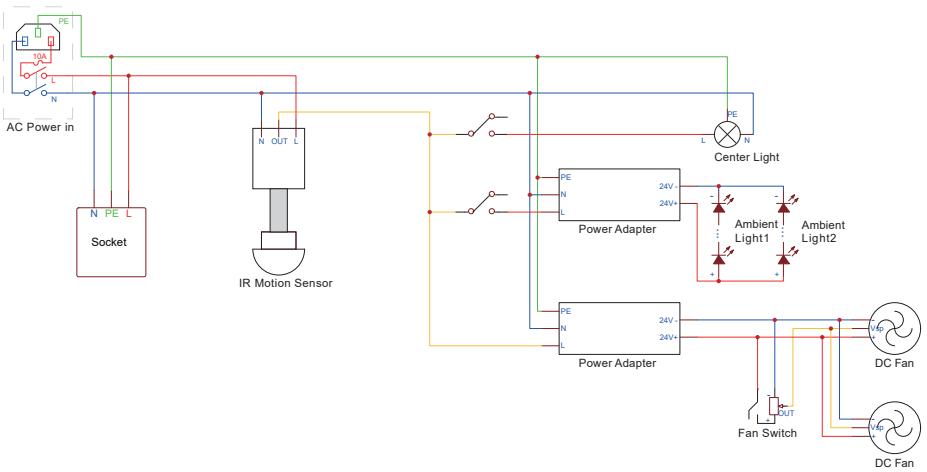

PRODUCT INTRODUCTION

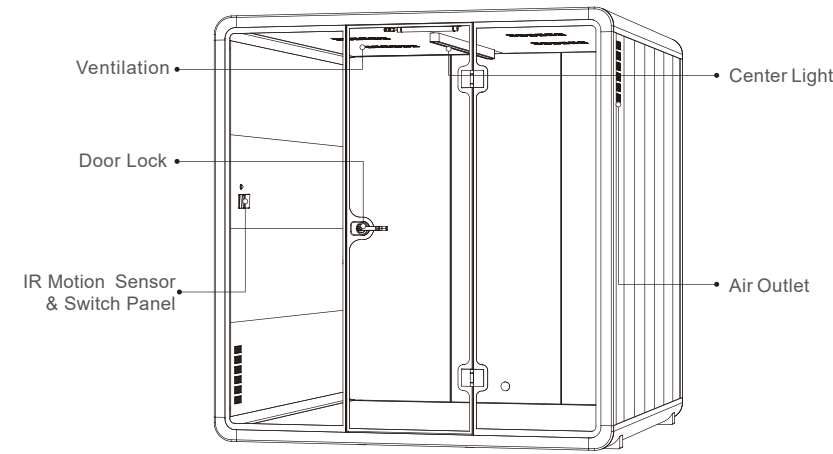

LARGE BOOTH

PART LIST

A-00	Aluminim
B-00	Carbon Plastic Panel
C-00	Glass
D-00	Metal Hardware
E-00	Upholstery
F-00	Electronics
G-00	Seal Strip
H-00	Accessory
Y-00	Tool

Tools				
Code	Description	Qty.	Preview	
Y-01	Torx Wrench	1		
Y-02	Rubber Mallet	1		
Y-03	Plastic Crowbar	1		
Y-04	Allen Wrench	2		
Y-05	CrossHead Screwdriver	1		
Y-06	Vacuum Handle	4		

Aluminium				
Code	Description	Qty.	Preview	
A-01	ArcBeam-Upper(L)	1		
A-02	ArcBeam-Upper(R)	1		
A-03	ArcBeam-lower(L)	1		
A-04	ArcBeam-lower(R)	1		
A-05	FrontFrame-Upper	1		
A-06	RearFrame-Upper	1		
A-07	FrontFrame-Lower	1		
A-08	RearFrame-Lower	1		
A-09	Front Frame (L)	1		
A-10	Rear Frame (L)	1		
A-11	Front Frame (R)	1		
A-12	Rear Frame (R)	1		
A-15-22	Corner Cover	8		
A-23	Ambient Light Channel	2		
A-27	Squaretube	2		
Carbon Plastic Panel				
B11-17	Side Panel(L)	7		
B21-27	Side Panel(R)	7		
B31-37	Top Panel	7		
B41-47	Bottom Panel	7		
B51-61	Reinforced Floor Panel	10/11		

Glass				
Code	Description	Qty.	Preview	
C-02	Door	1		
C-01	Glass Wall-Front(L)	1		
C-03	Glass Wall-Front(R)	1		
C-04	Glass Wall-Rear(L)	1		
C-05	Glass Wall-Rear(M)	1		
C-06	Glass Wall-Rear(R)	1		
Metal Hardware				
D-03	Door Lock	1		
D-04	Door Closer	1		
D-05	Door Hinge	2		
Upholstery				
E11-14	Acoustic Panel(L)	4		
E21-24	Acoustic Panel(R)	4		
E31	Acoustic Ceiling Panel(L)	1		
E32	Acoustic Ceiling Panel(R)	1		
E-51	Carpet	1		

Electronics				
F-06	Light Switch	1		
F-07	Fan Switch	1		
F-09	IR Motion Sensor	1		
F-10	Center Light	1		
Seal Strip				
Code	Description	Qty.	Preview	
G-01	Silicone Seal Strip	1		
G-21-22	Acrylic adhesive strip Back glass	2		
G-23	T-Strip	2		
Accessory				
H-01	Power Cord	1		
H-02	Screw Hole Sticker	16		
H-03	Safety Hammer	1		
H-04	Bottom Panel Pad	14		
H-05	Wire Hole Cover	1		

ASSEMBLY INSTRUCTIONS

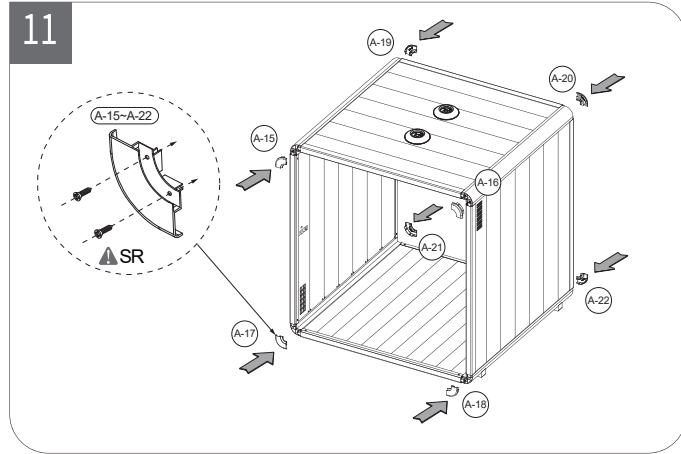
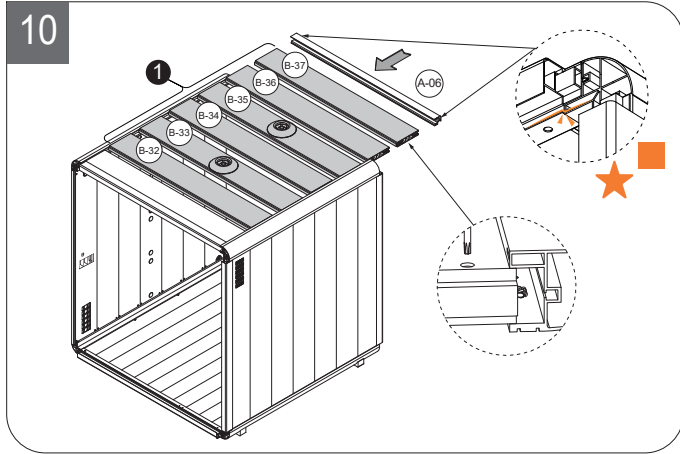
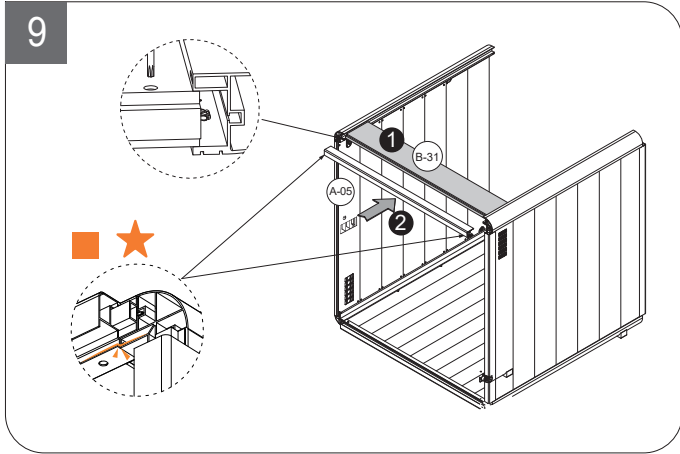
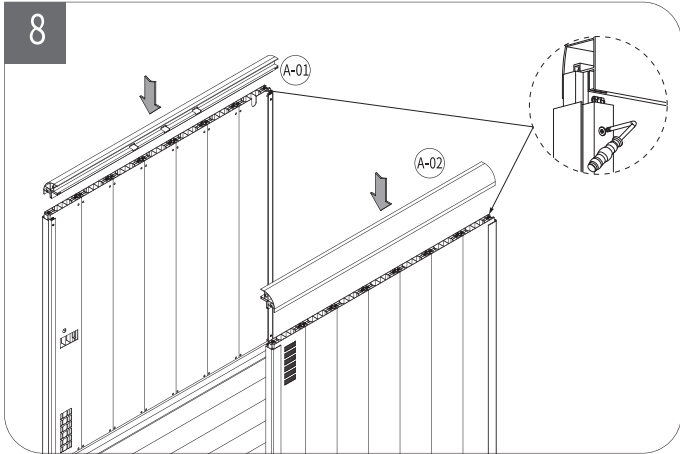
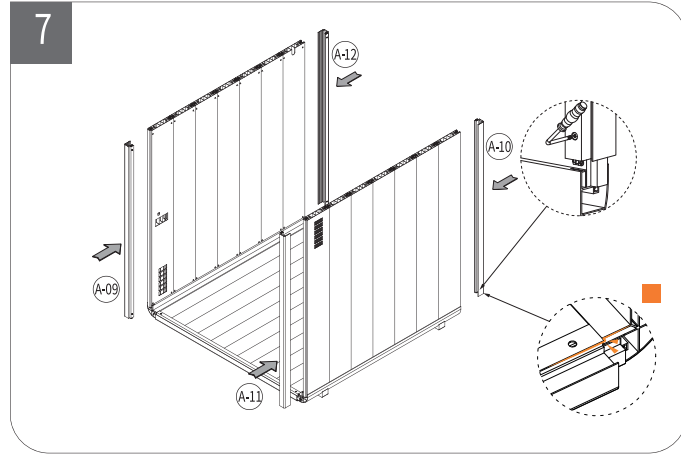
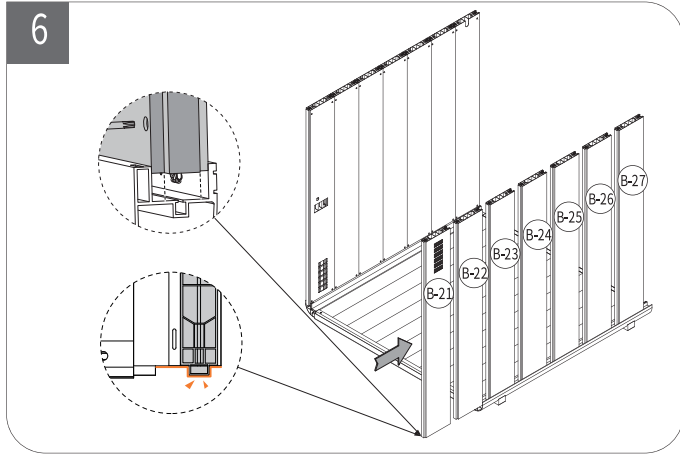
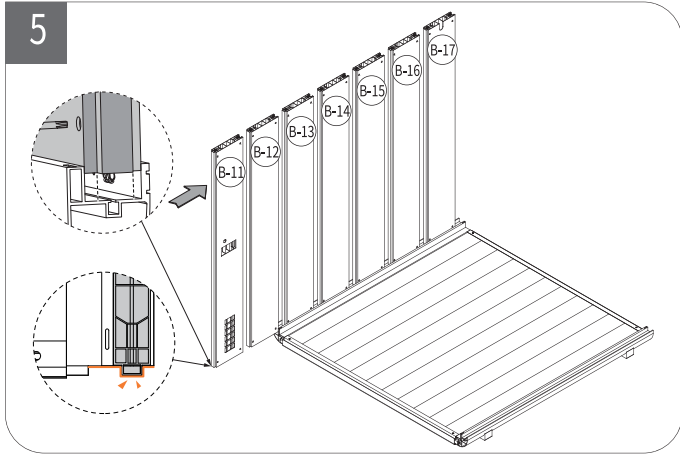
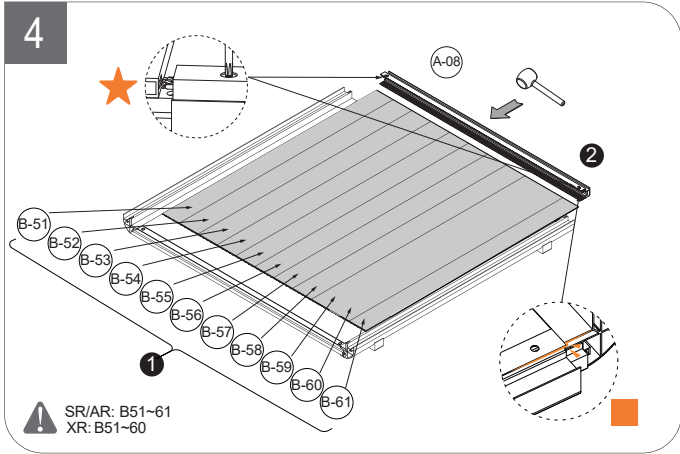
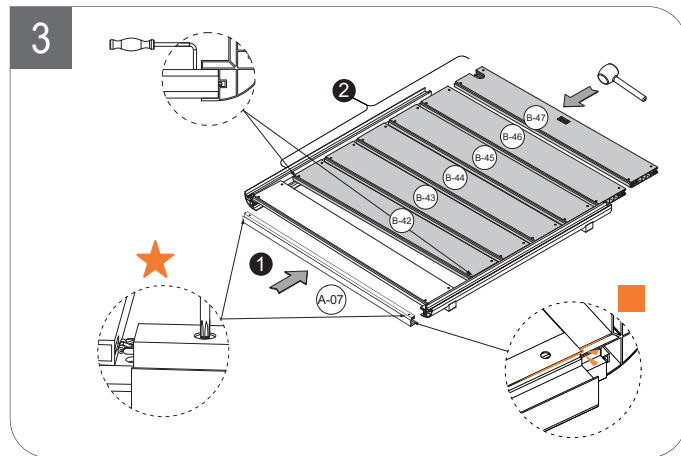
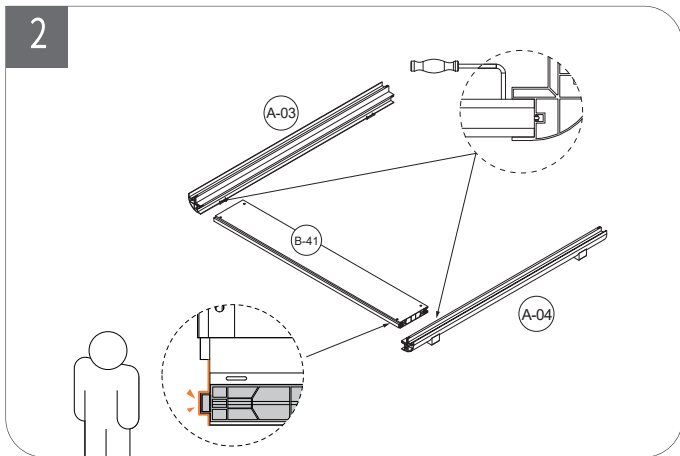
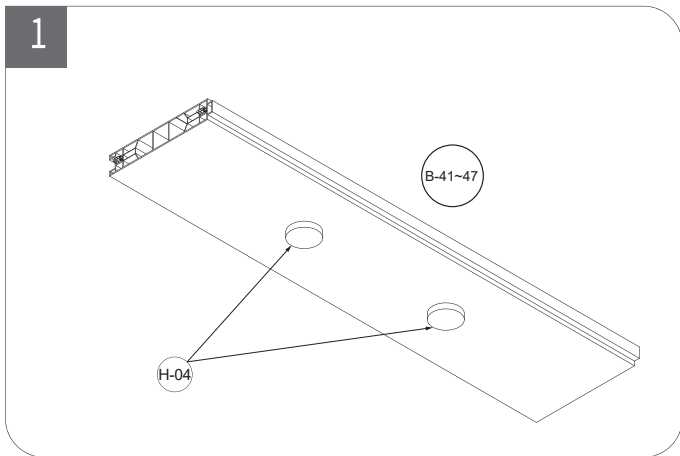
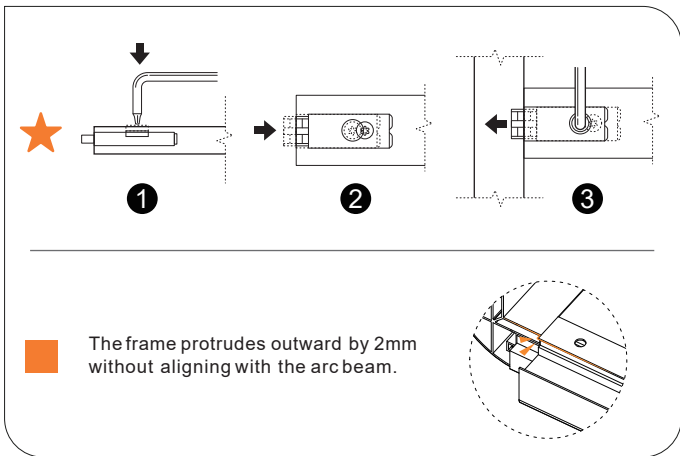

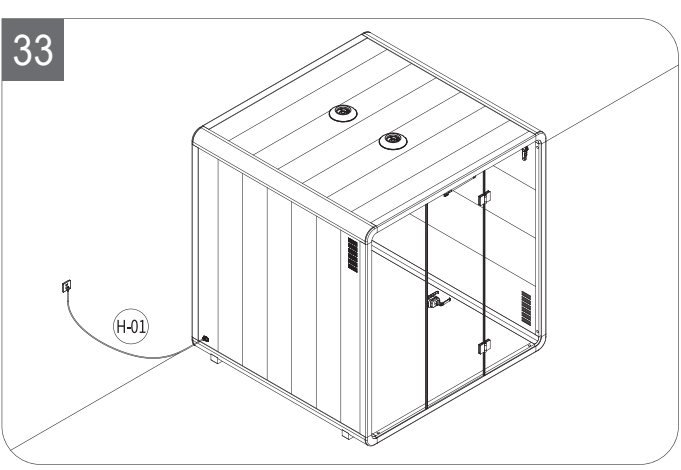
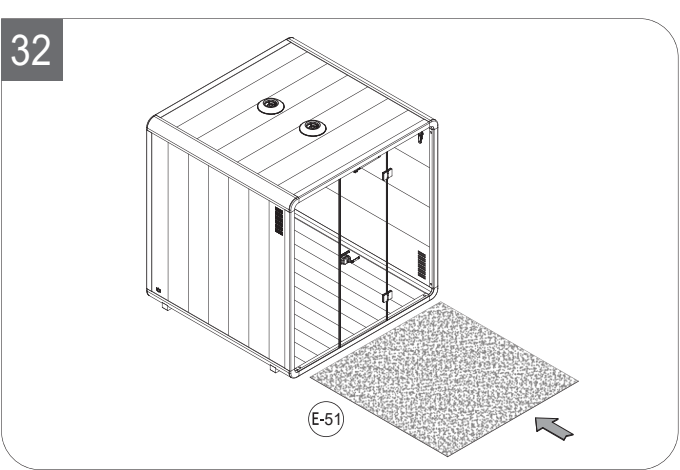
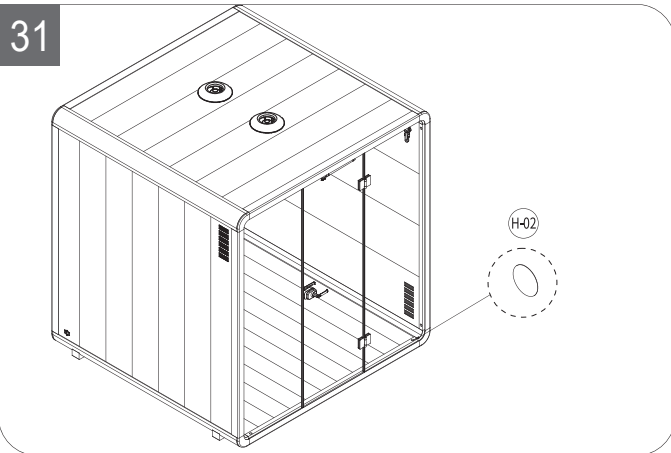
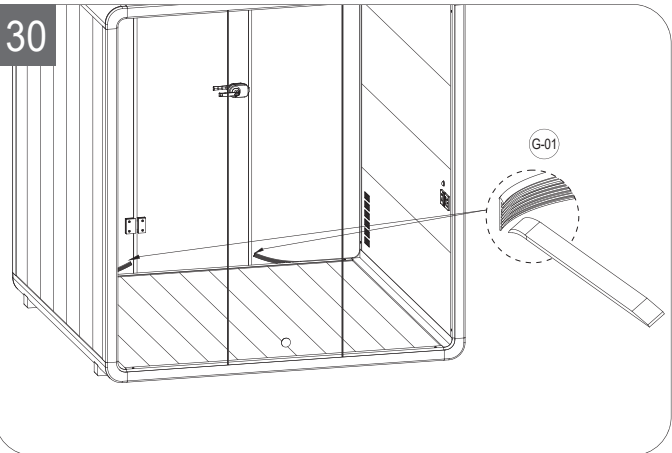
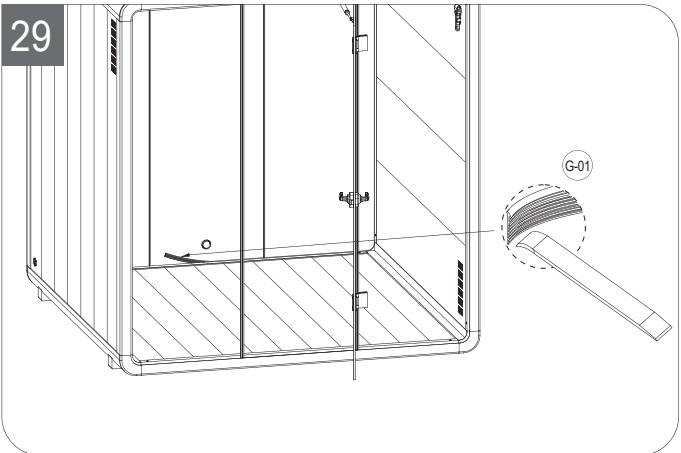
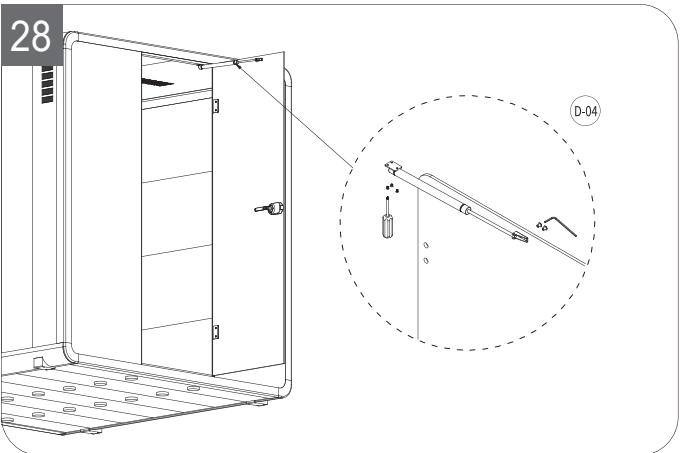
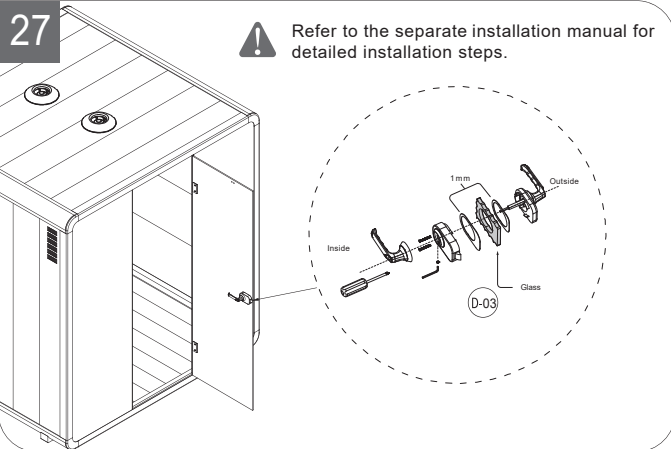
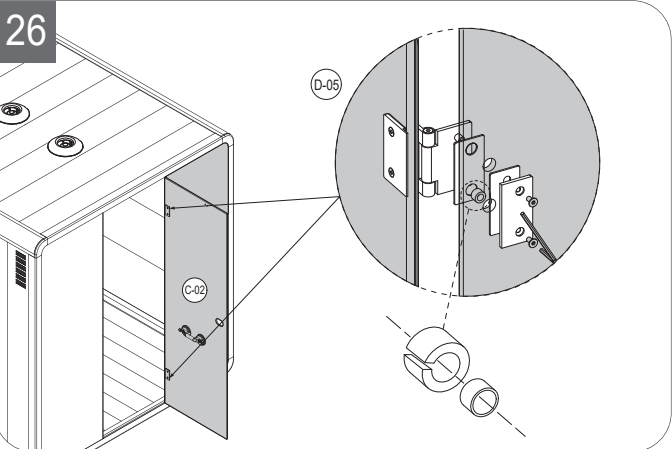
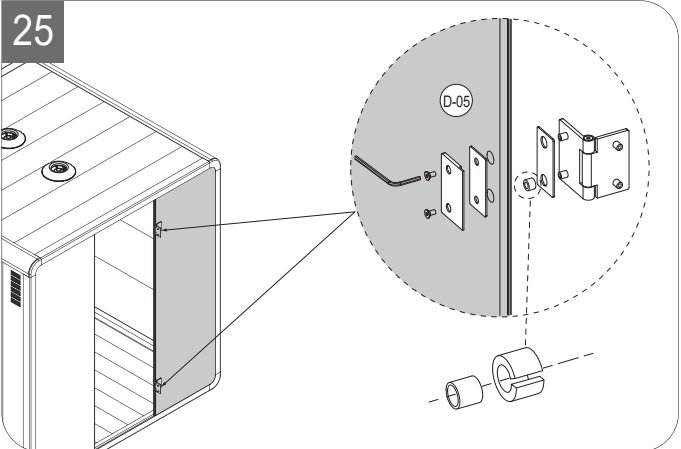
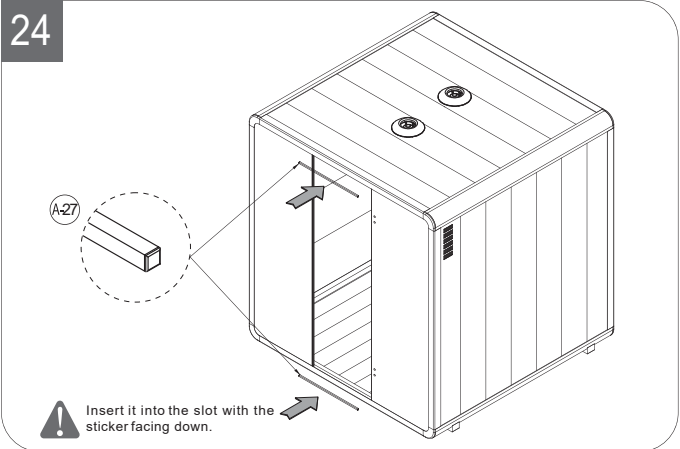
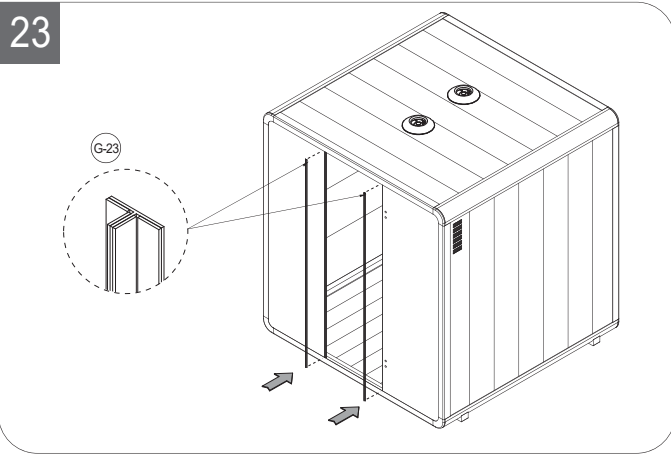
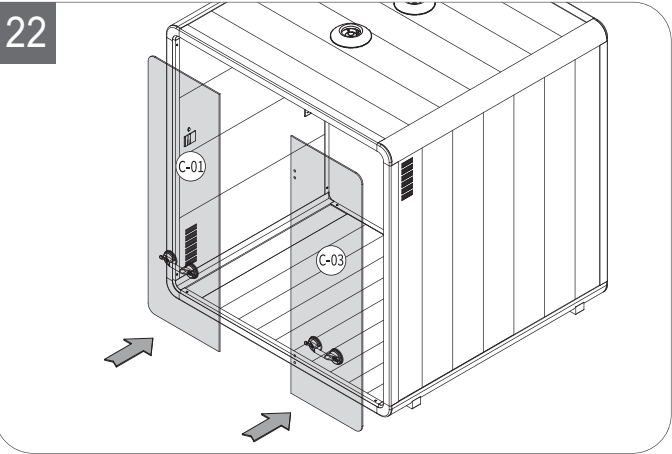
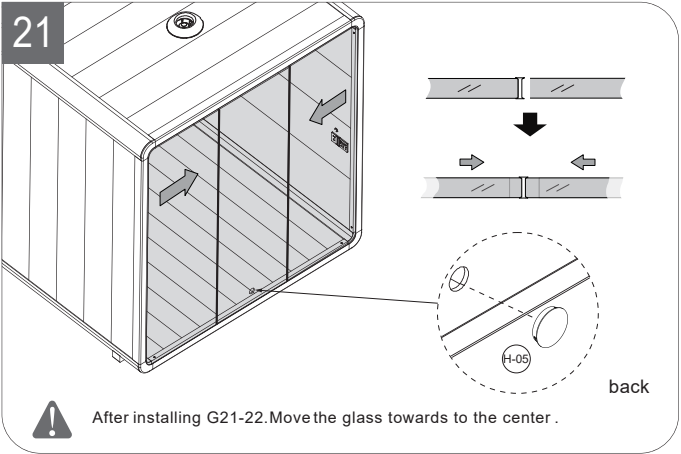
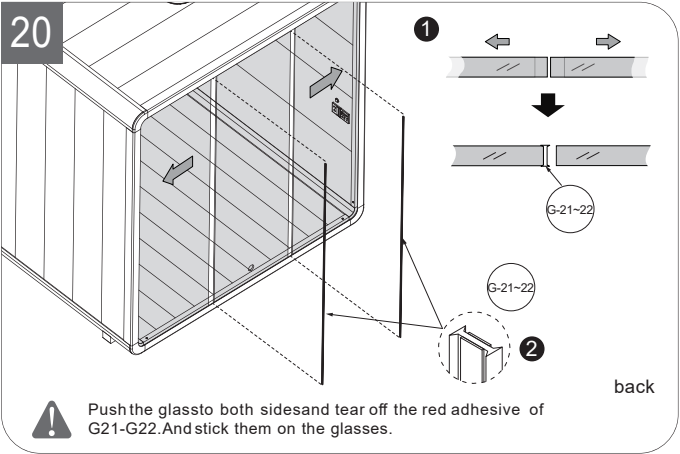
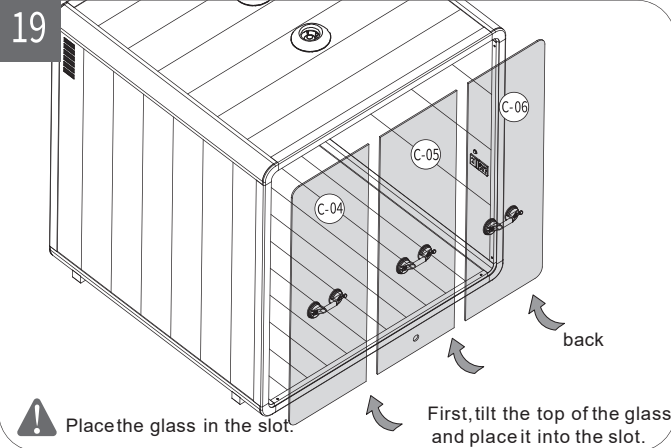
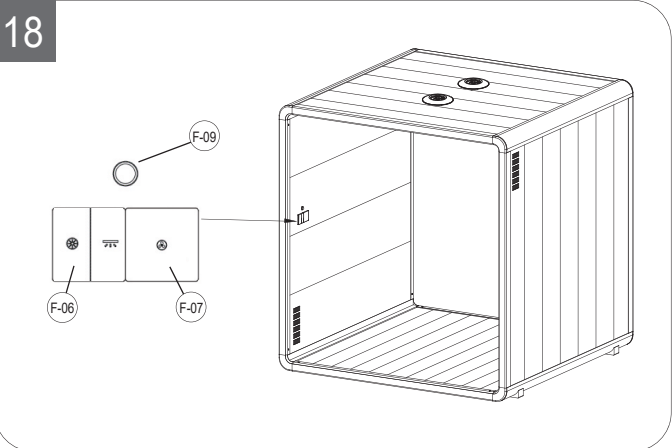
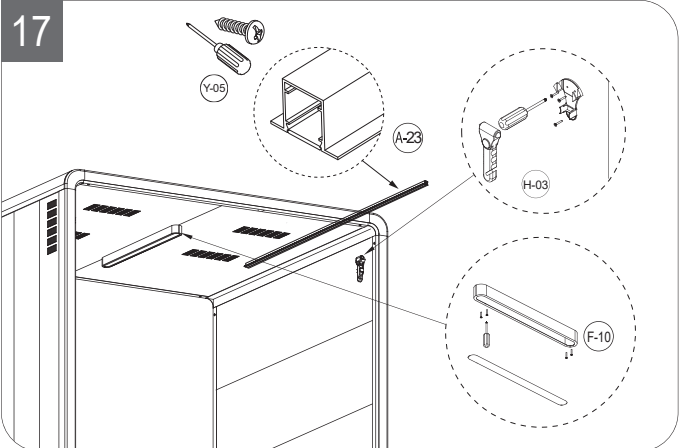
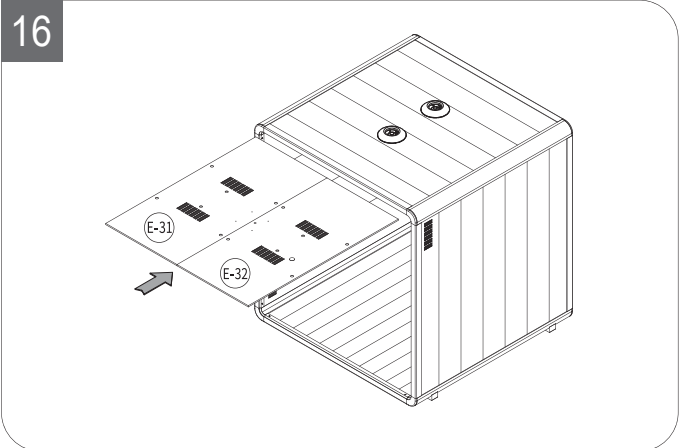
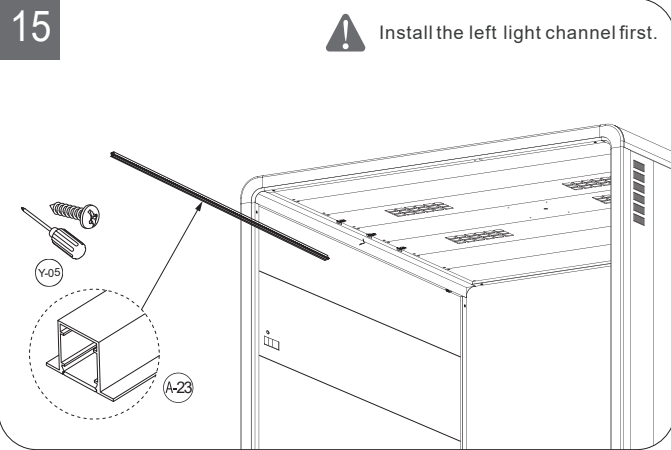
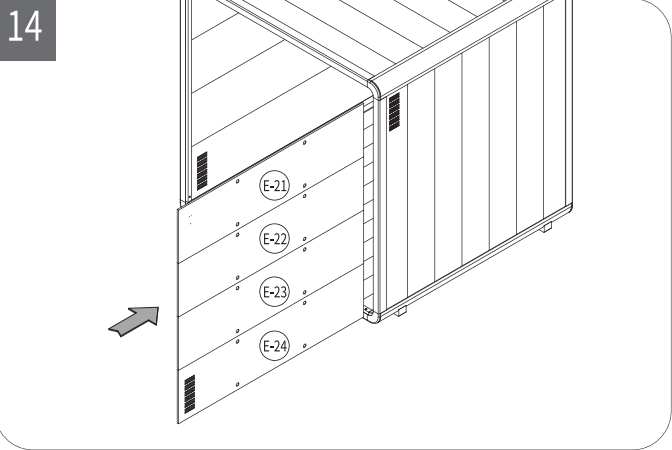
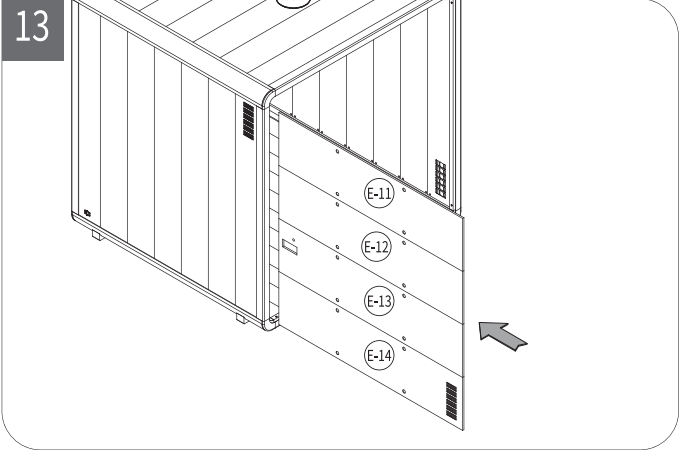
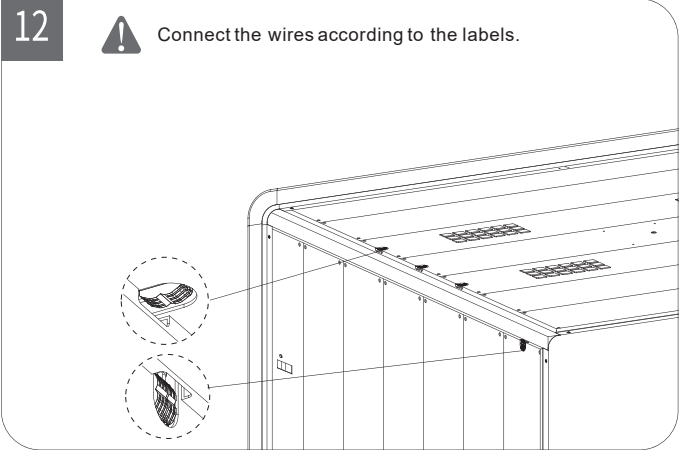

TABLE

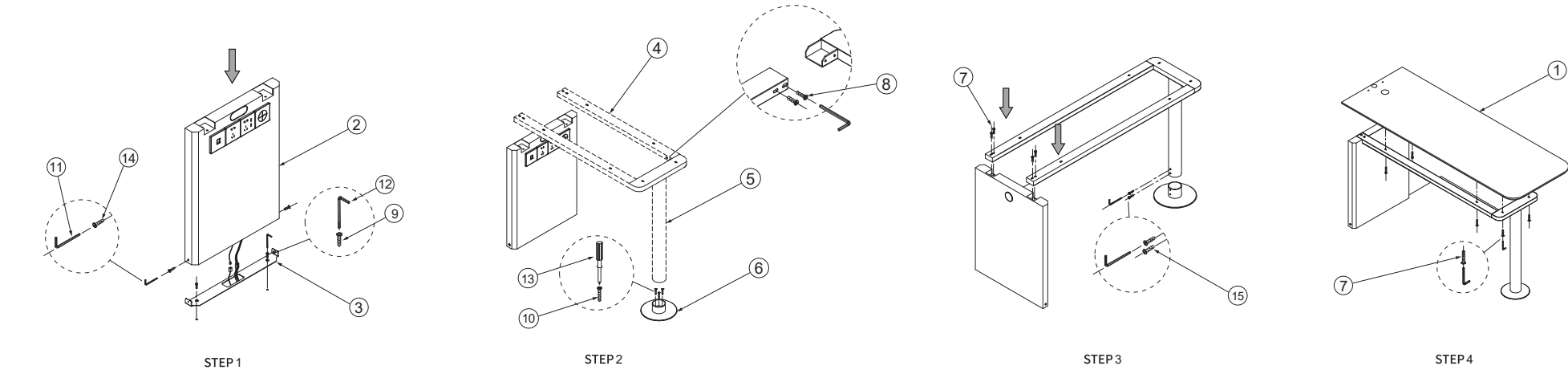

Part List

Code	Description	Qty.
1	Desk Panel	1
2	Main Pillar	1
3	Main Pillar Board	1
4	Frame Kit1	2
5	Frame Kit2	1
6	Pillar Holder	1
7	Screw M6*45mm	10
8	Screw M6*15mm	4
9	Screw M6*25mm	2
10	Screw ST4*30mm	3
11	Allen Wrench 3.0	1
12	Allen Wrench 4.0	1
13	Crosshead Screwdriver	1
14		2
15	Screw M5*12mm	2

CAUTIONS

Warning

- Do not use any electronics exceeding 1000W in case of overload.
- Do not use the product if the ventilation channels are blocked, keep the ventilation channels free from foreign objects and debris.
- Protect all electric hardware from damage, which could cause electrical leakage.
- Do not modify the product in case of a short circuit.

- Do not scratch glass with any sharp object.
- Do not smoke or light fires in the pod.
- Always set the casters to the non-moving state.
- Disconnect the power cord from the power outlet before starting any cleaning, maintenance, or disassembly procedures.
- Do not use the product if the ventilation is not functioning.

- Do not climb on top of the product or place any load on the top of the product.
- Do not use this product in an environment with oxygen concentration lower than 20%.
- Do not slam the door.
- Do not use this product outdoors.

Maintenance & Care

- Please contact authorized personnel for repairing, don't operate without official instruction.
- Do not put anything heavier than 10kg on the desk.
- Cut-off the power immediately if any malfunction occurs.

Problem & Solution

- In case of no power from the power outlets and the fan or lamp doesn't work.
- Make sure the power cord is plugged in properly.
- Check if the fuse is burnt out.
- Check that the wire terminal is firmly connected to the wire following the correct label.